

**Tattershall Drive
Hemel Hempstead HP2 7QG
£1,850 PCM**

- Three Bedroom Family Home
- NEW CARPETS to the ground floor & FRESH PAINT are being arranged
- Easy Access For The Motorway And Industrial Estate
- Close To Local Shops And Amenities
- French Doors Onto Garden
- Open Plan Lounge - Diner
- EPC - D
- Council Tax - D
- Available Now
- Holding Deposit - £426



67 Marlowes
Hemel Hempstead
Hertfordshire
HP1 1LE

01442 233533

homes@squireestates.co.uk

squireestates.co.uk

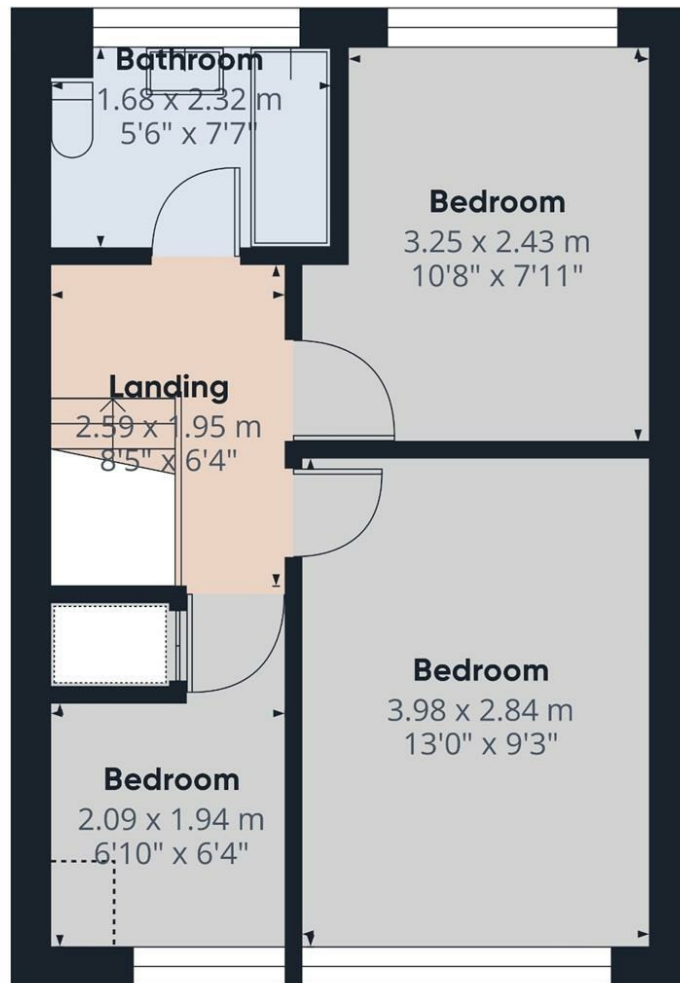

Floor 1

Approximate total area⁽¹⁾

31.99 m²
344.34 ft²

Reduced headroom

0.38 m²
4.05 ft²

(1) Excluding balconies and terraces

Reduced headroom

..... Below 1.5 m/5 ft

While every attempt has been made to ensure accuracy, all measurements are approximate, not to scale. This floor plan is for illustrative purposes only.

Calculations are based on RICS IPMS 3C standard.