

**Belswains Lane
Hemel Hempstead HP3 9XB
£1,100 PCM**

- One bedroom maisonette
- Excellent sized loft conversion
- Rear Garden
- Off road parking
- Must be seen!
- Gas central heating
- Walking distance to Apsley Marina & Mainline station
- Available from 12/04/25
- EPC - D
- Council Tax - B



67 Marlowes
Hemel Hempstead
Hertfordshire
HP1 1LE

01442 233533

homes@squireestates.co.uk

squireestates.co.uk

Ground Floor
Approx. 4.6 sq. metres (50.0 sq. feet)



First Floor
Approx. 38.6 sq. metres (415.3 sq. feet)



Second Floor
Approx. 19.2 sq. metres (206.6 sq. feet)

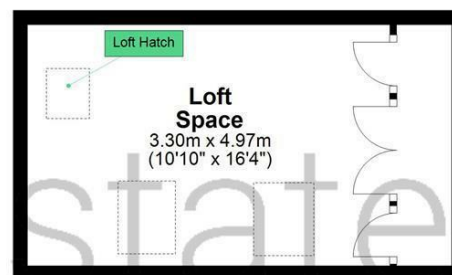

Total area: approx. 62.4 sq. metres (671.9 sq. feet)

Disclaimer - Floor plan is for marketing purposes only and is to be used as a guide - SKM Studio
Plan produced using PlanUp.