

**FOR
SALE**

Handleys Court Selden Hill, Hemel Hempstead

squire | estates

This modern two-bedroom, two-bathroom apartment is one of the biggest properties within this a complex and offers an ideal living space for those seeking convenience, comfort, and style.

The apartment features a spacious large entrance hall with built-in storage cupboards, providing ample space for coats, shoes, etc.

Inside, the large open-plan living area has a Juliette balcony, a good size lounge seating area, space for a dining table and a well-appointed kitchen designed with contemporary fittings and appliances including fridge/freezer, dishwasher and washing machine.

Both bedrooms are generously sized with the master bedroom featuring an en-suite shower room. The second bathroom is equally stylish and well-equipped.

Additional highlights of the property include access to a beautiful communal rooftop terrace with stunning views, a great space for outdoor relaxation and entertaining guests.

The property benefits from secure allocated parking, providing peace of mind and convenience,



Floor Plan

Approx. 75.4 sq. metres (811.8 sq. feet)

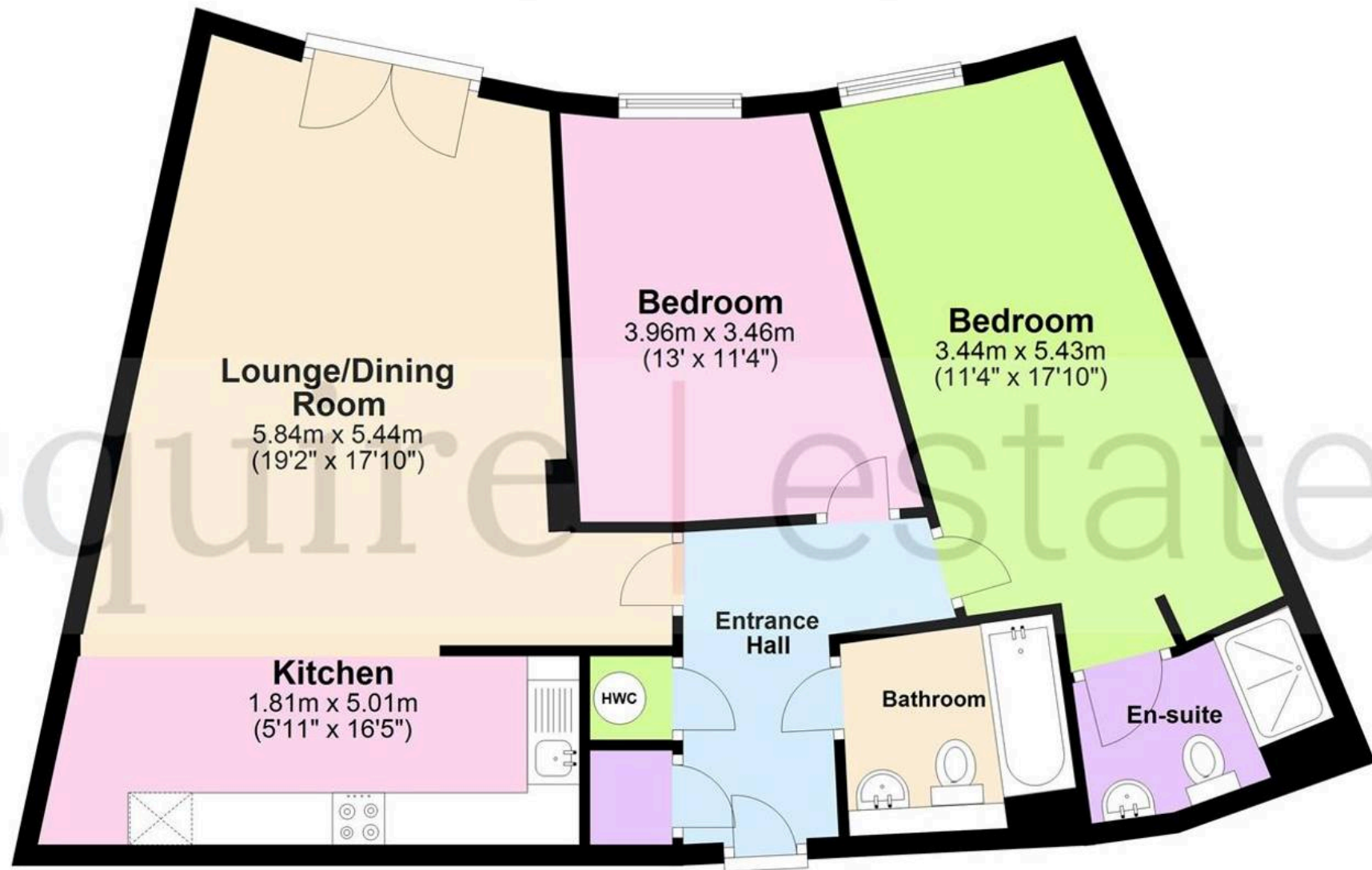

Total area: approx. 75.4 sq. metres (811.8 sq. feet)

The Floor Plan is not to Scale and measurements and areas shown are approximate and therefore should be used for illustrative purposes only. The plan has been prepared with due diligence and whilst we have confidence in the information produced it should not be relied upon. Maximum lengths and widths are represented on the plan. If there are any aspects of particular importance, you should carry out or commission your own inspection of the property.

Copyright © SKMSTUDIO
Plan produced using PlanUp.



squire | estates

67 Marlowes, Hemel Hempstead
Hertfordshire HP1 1LE
t. 01442 233533

www.squireestates.co.uk