

**King Edward Street  
Hemel Hempstead HP3 0AD  
£1,650 PCM**

- Small Pets Welcome
- Open plan kitchen/dining/lounge
- Two double bedrooms
- Guest cloakroom
- Off street parking
- Available Now
- Courtyard garden
- Close to Apsley main line station
- EPC - B
- Council tax - D



67 Marlowes  
Hemel Hempstead  
Hertfordshire  
HP1 1LE

01442 233533

homes@squireestates.co.uk

squireestates.co.uk

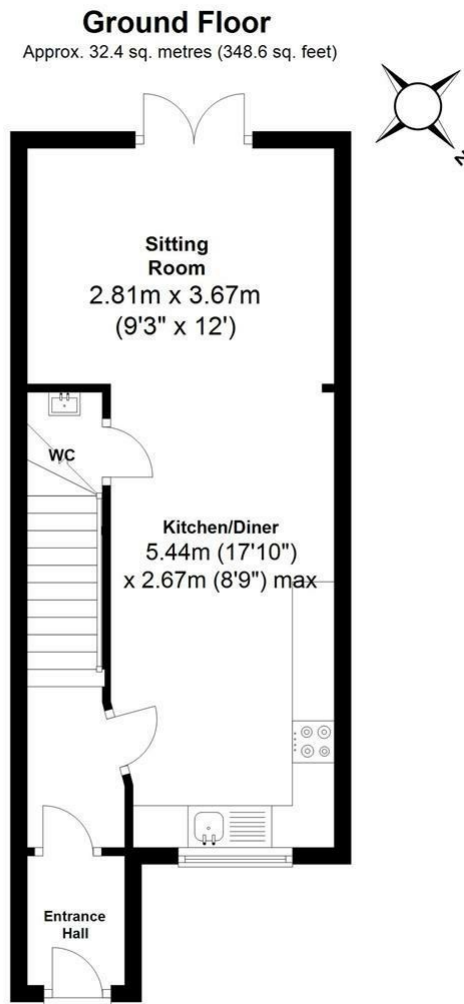

**First Floor**  
Approx. 30.0 sq. metres (322.6 sq. feet)

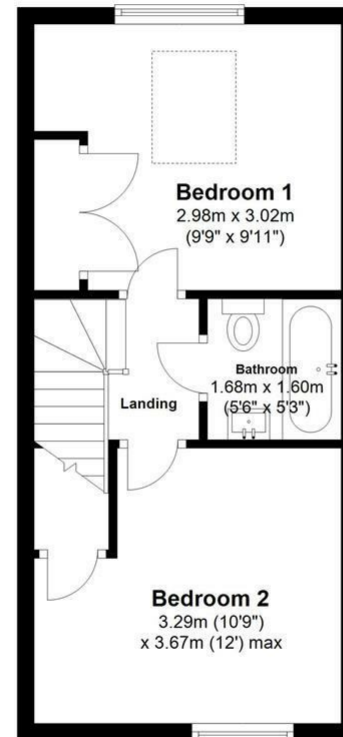

Total area: approx. 62.4 sq. metres (671.2 sq. feet)