

**Barnacres Road
Hemel Hempstead HP3 8JR
£1,950 PCM**

- Three Bedroom House
- One Bathroom - One Shower Room
- Off Road Parking for 2 cars
- Great School Catchment Area
- Walking Distance To Station
- Available from 7th June 2025
- EPC - D
- Council tax - C
- Holding deposit - £450



67 Marlowes
Hemel Hempstead
Hertfordshire
HP1 1LE

01442 233533

homes@squireestates.co.uk

squireestates.co.uk

Ground Floor

Approx. 41.4 sq. metres (446.1 sq. feet)



First Floor

Approx. 41.5 sq. metres (446.4 sq. feet)

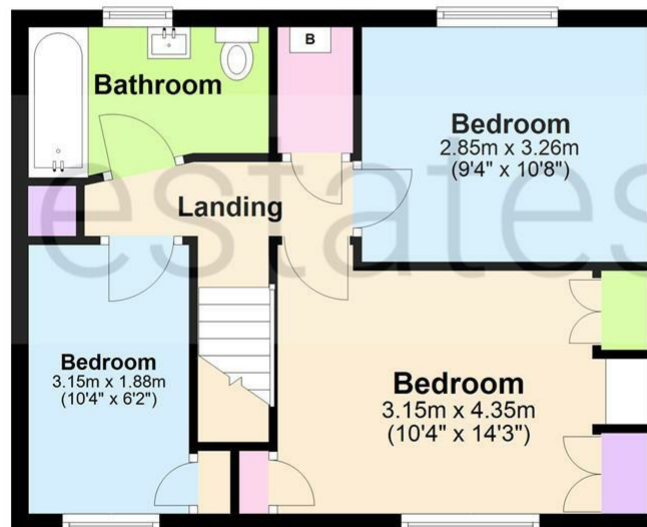

Total area: approx. 82.9 sq. metres (892.5 sq. feet)

The Floor Plan is not to Scale and measurements and areas shown are approximate and therefore should be used for illustrative purposes only. The plan has been prepared with due diligence and whilst we have confidence in the information produced it should not be relied upon. Maximum lengths and widths are represented on the plan. If there are any aspects of particular importance, you should carry out or commission your own inspection of the property. Copyright © SKMSTUDIO
Plan produced using PlanUp.