

**New Park Drive
Hemel Hempstead HP2 4QJ
£1,650 PCM**

- Recently built two-bedroom home
- Ground floor W/C
- 678 sq ft of modern living space
- Open-plan kitchen with integrated appliances
- Gas central heating throughout
- Large private rear garden
- Off-road parking
- Available Now
- EPC - B
- Council Tax - C



67 Marlowes
Hemel Hempstead
Hertfordshire
HP1 1LE

01442 233533

homes@squireestates.co.uk

squireestates.co.uk

Ground Floor

Approx. 31.7 sq. metres (341.5 sq. feet)



First Floor

Approx. 31.3 sq. metres (336.8 sq. feet)

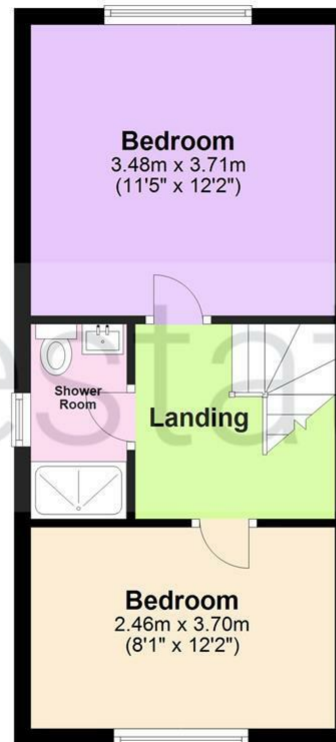

Total area: approx. 63.0 sq. metres (678.3 sq. feet)

The Floor Plan is not to Scale and measurements and areas shown are approximate and therefore should be used for illustrative purposes only. The plan has been prepared with due diligence and whilst we have confidence in the information produced it should not be relied upon. Maximum lengths and widths are represented on the plan. If there are any aspects of particular importance, you should carry out or commission your own inspection of the property. Copyright © SKMSTUDIO

Plan produced using PlanUp. □