

**Paston Road
Hemel Hempstead HP2 5AP
£1,750 PCM**

- Three bedroom family home
- Converted Garage/workshop
- Conservatory
- Located near to local shops
- Option of fully furnished/ Un-furnished
- Available from 05/07/25
- Downstairs W/C
- Close to schools
- Council tax - D
- EPC - D



67 Marlowes
Hemel Hempstead
Hertfordshire
HP1 1LE

01442 233533

homes@squireestates.co.uk

squireestates.co.uk

Ground Floor

Approx. 56.8 sq. metres (611.0 sq. feet)



First Floor

Approx. 38.9 sq. metres (419.0 sq. feet)

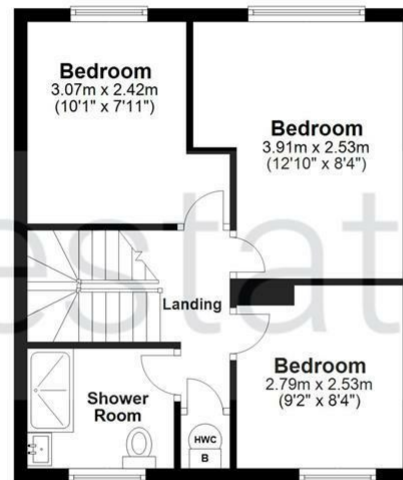

Total area: approx. 95.7 sq. metres (1030.0 sq. feet)

Disclaimer - Floor plan is for marketing purposes only and is to be used as a guide - SKM Studio
Plan produced using PlanUp.