

**Paston Road  
Hemel Hempstead HP2 5AP  
£1,800 PCM**

- Three bedroom family home
- Converted Garage/workshop
- Conservatory
- Located near to local shops
- FULLY FURNISHED
- Available from 05/07/25
- Downstairs W/C
- Close to schools
- Council tax - D
- EPC - D





67 Marlowes  
Hemel Hempstead  
Hertfordshire  
HP1 1LE

01442 233533

homes@squirestates.co.uk

squirestates.co.uk

### Ground Floor

Approx. 56.8 sq. metres (611.0 sq. feet)

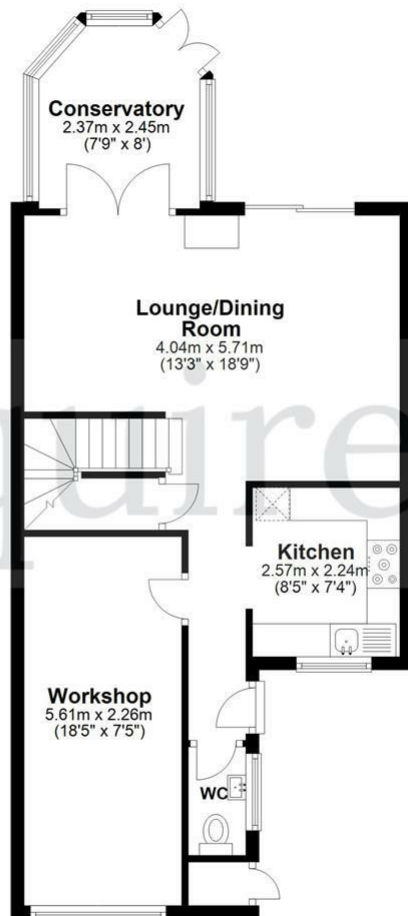

### First Floor

Approx. 38.9 sq. metres (419.0 sq. feet)

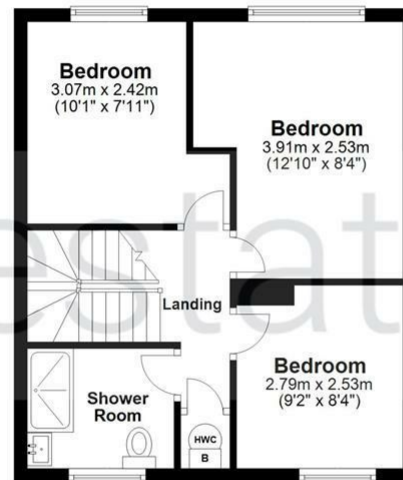

Total area: approx. 95.7 sq. metres (1030.0 sq. feet)

Disclaimer - Floor plan is for marketing purposes only and is to be used as a guide - SKM Studio  
Plan produced using PlanUp.