

**St. Pauls Road
Hemel Hempstead HP2 5DD
£2,100 PCM**

- Three bedroom Detached family home
- Pets accepted
- Fitted kitchen
- Lounge
- Family room/study/annex
- Fully tiled luxury bath/shower room
- Available 27th September 2025
- EPC - B
- Council Tax - E
- Holding deposit - £484



67 Marlowes
Hemel Hempstead
Hertfordshire
HP1 1LE

01442 233533

homes@squireestates.co.uk

squireestates.co.uk

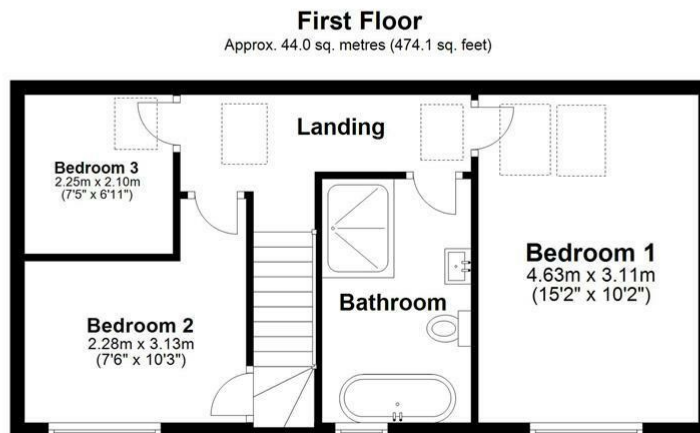

Total area: approx. 85.3 sq. metres (918.3 sq. feet)

Disclaimer - Floor plan is for marketing purposes only and is to be used as a guide - SKM Studio
Plan produced using PlanUp.