

**Parkhill Road
Hemel Hempstead HP1 1TP
£1,950 PCM**

- Boxmoor Location
- Three Bedroom House
- Conservatory
- Off Road Parking
- Spacious Lounge
- Available 04/10/2025
- Downstairs W/C
- EPC - D
- Council tax - D
- Holding Deposit £450



67 Marlowes
Hemel Hempstead
Hertfordshire
HP1 1LE

01442 233533

homes@squireestates.co.uk

squireestates.co.uk

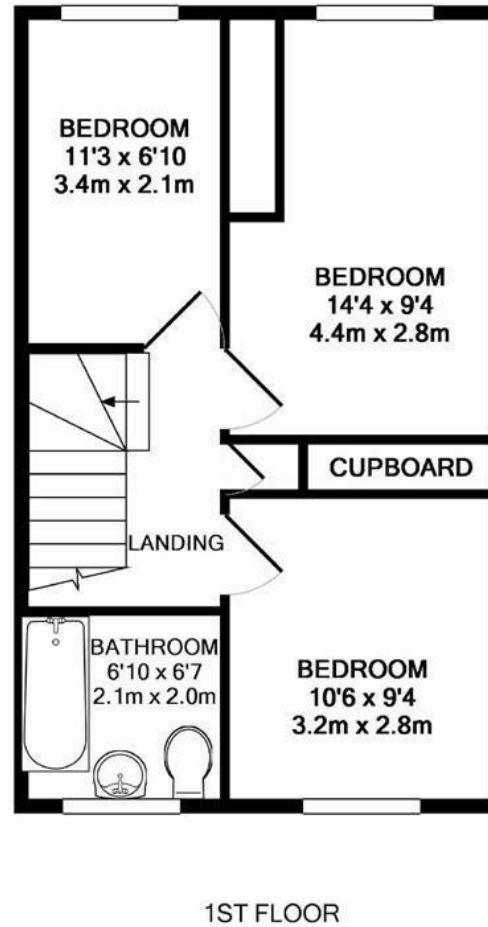
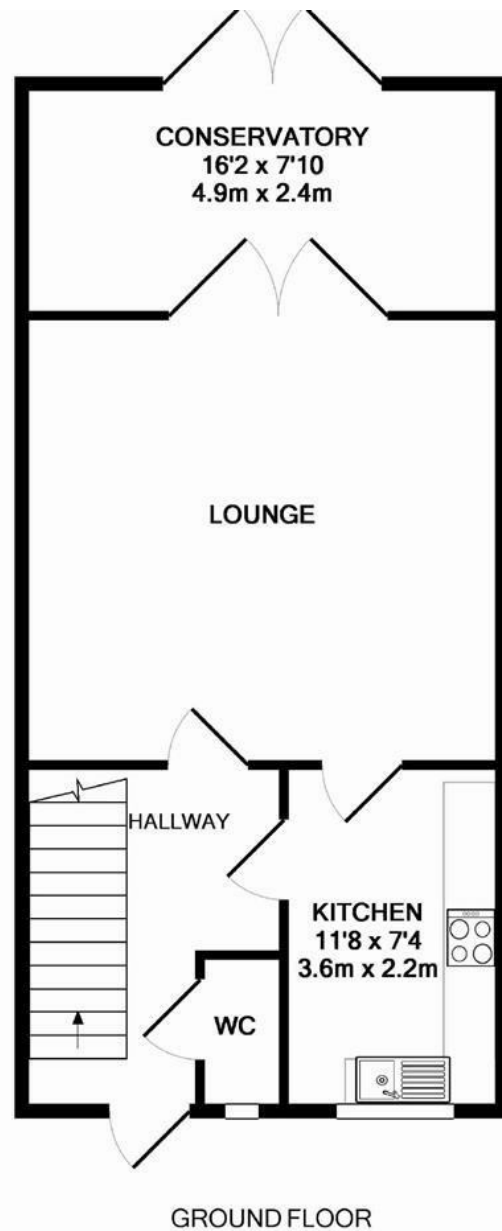

Whilst every attempt has been made to ensure the accuracy of the floor plan contained here, measurements of doors, windows, rooms and any other items are approximate and no responsibility is taken for any error, omission, or mis-statement. This plan is for illustrative purposes only and should be used as such by any prospective purchaser. The services, systems and appliances shown have not been tested and no guarantee as to their operability or efficiency can be given
Made with Metropix ©2014