

**Datchworth Turn
Hemel Hempstead HP2 4NY
£850 PCM**

- Close To Industrial Estate
- Large Studio
- Gas Central Heating
- Available 20th October 2025
- Parking
- EPC - D
- Council Tax - A



67 Marlowes
Hemel Hempstead
Hertfordshire
HP1 1LE

01442 233533

lettings@squireestates.co.uk

squireestates.co.uk

If you would like to apply for a property
please scan the QR code below...



Floor Plan

Approx. 25.2 sq. metres (271.7 sq. feet)

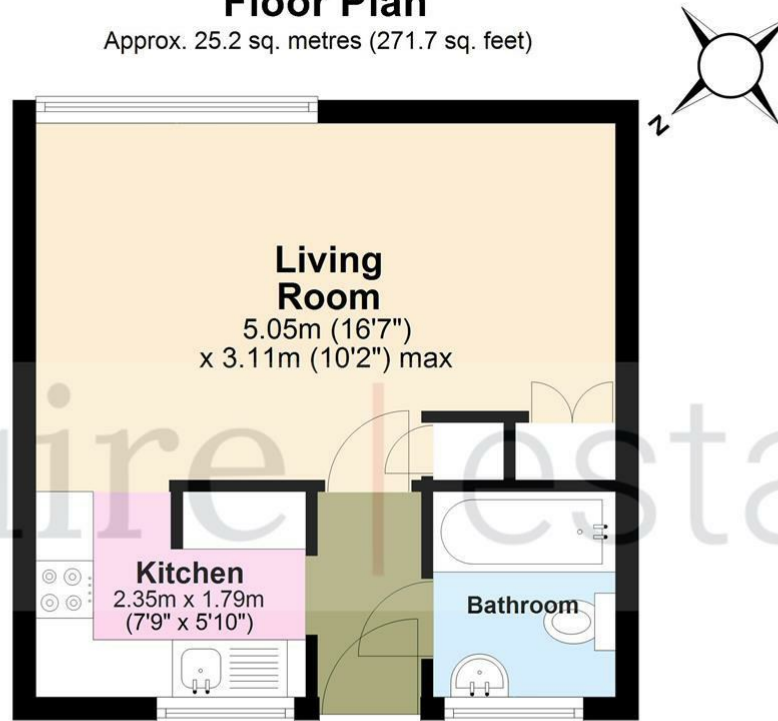

Total area: approx. 25.2 sq. metres (271.7 sq. feet)

The Floor Plan is not to Scale and measurements and areas shown are approximate and therefore should be used for illustrative purposes only. The plan has been prepared with due diligence and whilst we have confidence in the information produced it should not be relied upon. Maximum lengths and widths are represented on the plan. If there are any aspects of particular importance, you should carry out or commission your own inspection of the property. Copyright ©

SKMSTUDIO

Plan produced using PlanUp. □