



19, Chardins Close, Hemel Hempstead,  
, HP1 2QN

squire | estates

---



## 19, Chardins Close, Hemel Hempstead,,

Spacious & Well-Presented First Floor Three-Bedroom Maisonette

This beautifully presented and generously sized first floor three-bedroom maisonette offers stylish and comfortable living in a popular residential location.

Entering through your own private front door, you're welcomed into a spacious entrance hall with a large built-in storage cupboard and smart tiled flooring—ideal for coats, shoes, and everyday essentials.

Upstairs, the property opens into a bright and expansive living/dining area featuring a cosy log burner, perfect for relaxing or entertaining.

The accommodation includes two well-proportioned double bedrooms and a good-sized single bedroom, offering plenty of flexibility for families, guests, or home working. The property boasts excellent storage throughout, including access to a large loft space, perfect for storing seasonal items or offering potential for future conversion (subject to planning).

The sleek, modern bathroom is fully tiled and includes a stylish walk-in shower.

The contemporary kitchen is both functional and attractive, complete with grey granite worktops, a breakfast bar, tiled flooring, and integrated double oven and hob. A door from the kitchen leads to a small private balcony, providing a quiet outdoor space to enjoy.

Externally, the property benefits from a large private driveway, offering ample off-street parking.

Located close to local amenities and within easy reach of highly rated primary and secondary schools, this spacious home is ideal for families, professionals, or anyone looking for a well-appointed home with excellent storage and convenience.

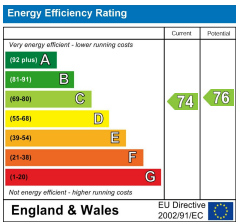

## Features

- 3 Bedroom Maisonette
- Lounge/dining
- Modern Kitchen
- Shower Room
- Driveway
- Balcony
- Close to Town Centre
- Close to Train Station
- Excellent Primary/Secondary Schools

Scan the QR Code to submit an offer



Please note we have not tested any apparatus, fixtures, fittings, or services. Interested parties must undertake their own investigation into the working order of these items. All measurements are approximate and photographs provided for guidance only.



## First Floor

Approx. 71.0 sq. metres (763.8 sq. feet)



## Ground Floor

Approx. 8.1 sq. metres (87.7 sq. feet)

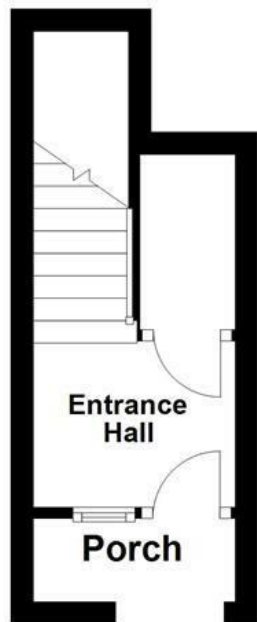

Total area: approx. 79.1 sq. metres (851.5 sq. feet)

Disclaimer - Floor plan is for marketing purposes only and is to be used as a guide - SKM Studio  
Plan produced using PlanUp.



