

**Christchurch Road
Hemel Hempstead HP2 5BX
£1,150 PCM**

- One double bedroom with bay window
- Contemporary open plan lounge / kitchenette
- Brand new fitted kitchen with integrated appliances
- Modern bathroom with shower
- Gas Central Heating
- Must Be Seen
- On-street permit parking (£30/month)
- EPC rating C
- Council tax band B
- Available from 27 October 2025



67 Marlowes
Hemel Hempstead
Hertfordshire
HP1 1LE

01442 233533

lettings@squirestates.co.uk

squirestates.co.uk

If you would like to apply for a property
please scan the QR code below...

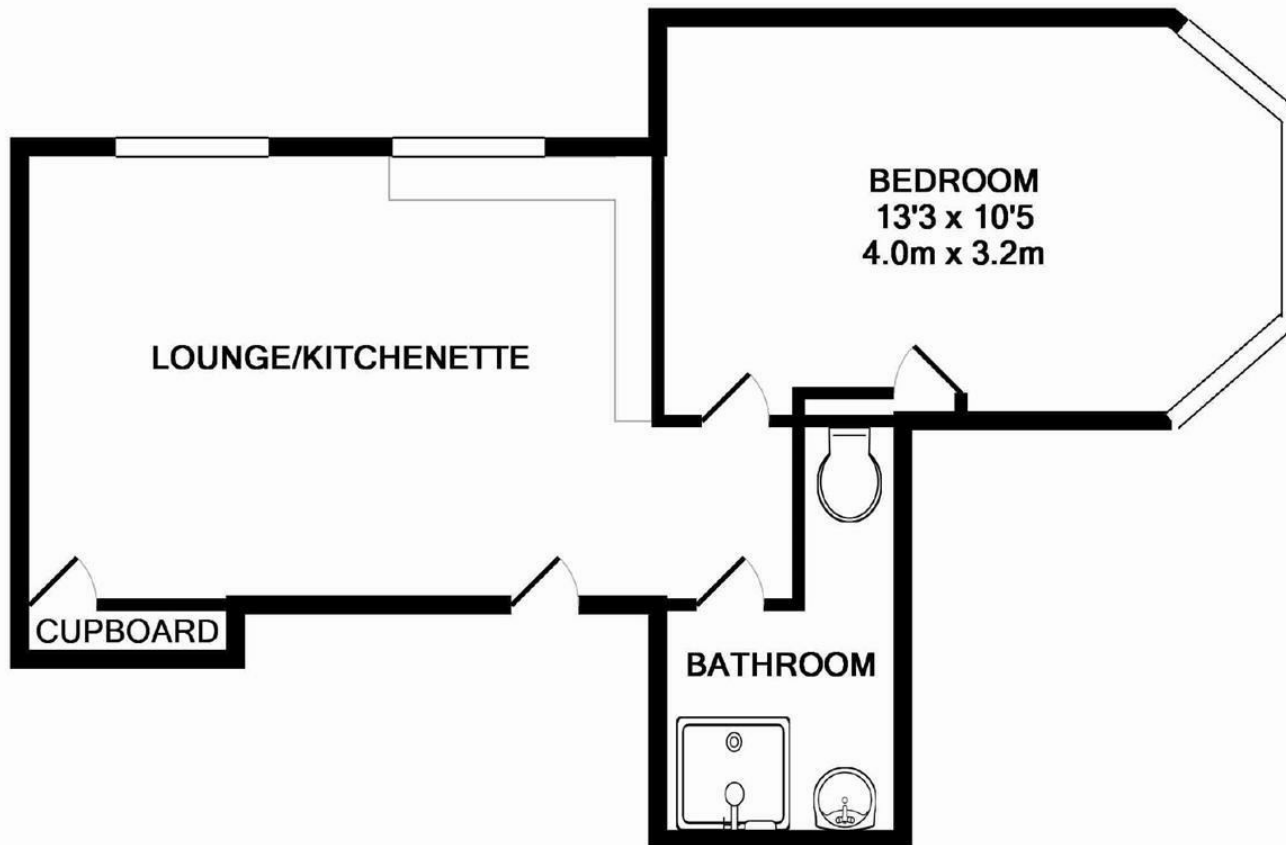

Whilst every attempt has been made to ensure the accuracy of the floor plan contained here, measurements of doors, windows, rooms and any other items are approximate and no responsibility is taken for any error, omission, or mis-statement. This plan is for illustrative purposes only and should be used as such by any prospective purchaser. The services, systems and appliances shown have not been tested and no guarantee as to their operability or efficiency can be given
Made with Metropix ©2014