

**Thorne Close  
Hemel Hempstead HP1 1LY  
£2,150 PCM**

- Three Bedroom Detached House
- Walkable to Hemel Hempstead Station (Direct Trains to Euston from 27 Minutes)
- Gas Central Heating
- Double Glazing
- Parking Bay & Visitor Spaces
- Boxmoor Location
- Available 24th November 2025
- Conservatory
- Family & En Suite Bathroom
- Downstairs W/C



67 Marlowes  
Hemel Hempstead  
Hertfordshire  
HP1 1LE

01442 233533

lettings@squireestates.co.uk

squireestates.co.uk

If you would like to apply for a property  
please scan the QR code below...

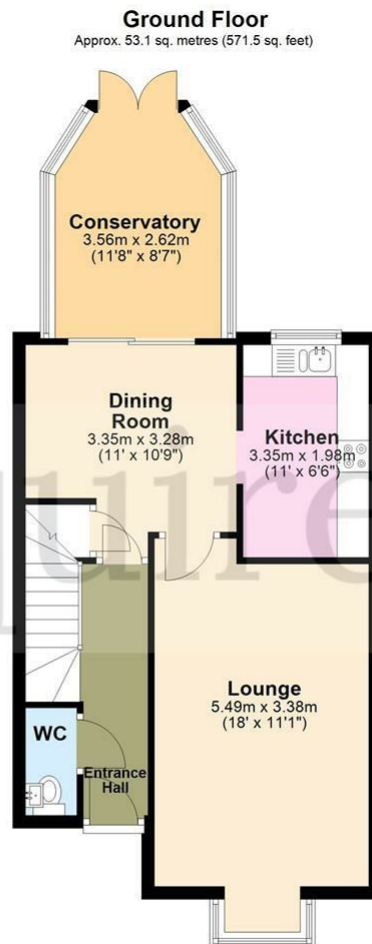

Total area: approx. 97.1 sq. metres (1044.8 sq. feet)

The Floor Plan is not to Scale and measurements and areas shown are approximate and therefore should be used for illustrative purposes only. The plan has been prepared with due diligence and whilst we have confidence in the information produced it should not be relied upon. Maximum lengths and widths are represented on the plan. If there are any aspects of particular importance, you should carry out or commission your own inspection of the property. Copyright © SKMSTUDIO  
Plan produced using PlanUp.