



## 55 Tattershall Drive, Hemel Hempstead, Hertfordshire HP2 7QF

### £1,000 PCM

Set on the mid floor of a well-kept block in Grovehill, this bright one-bedroom apartment looks out towards mature trees, giving the living space a calm, green backdrop. Inside, a generous lounge easily zones for dining and relaxing, while a separate fitted kitchen keeps cooking aromas away from the living area. The double bedroom comes with full-height windows and built-in storage, and the bathroom offers a classic three-piece suite with shower over bath. Practical touches include double-glazed windows and wall-mounted electric heating, plus a communal, unallocated car park with unrestricted use for residents and visitors.

Step outside and everyday essentials are close by at Henry Wells Square in Grovehill — convenience store, pharmacy and takeaways among the parade — so you can grab last-minute bits on foot.

For bigger shops, cafés and national brands head to The Marlowes in the town centre, while Jarman Park is your go-to for leisure with Cineworld, restaurants and The Snow Centre for year-round real-snow fun.

Commuting is straightforward: regular buses link Grovehill with the town and Hemel Hempstead station, and from there London Euston is typically around 27–32 minutes on London Northwestern Railway services.

At weekends, stretch your legs in Gadebridge Park, Dacorum's principal park with wide lawns, play areas and riverside walks.

Available 3rd November on a long-term basis, unfurnished.



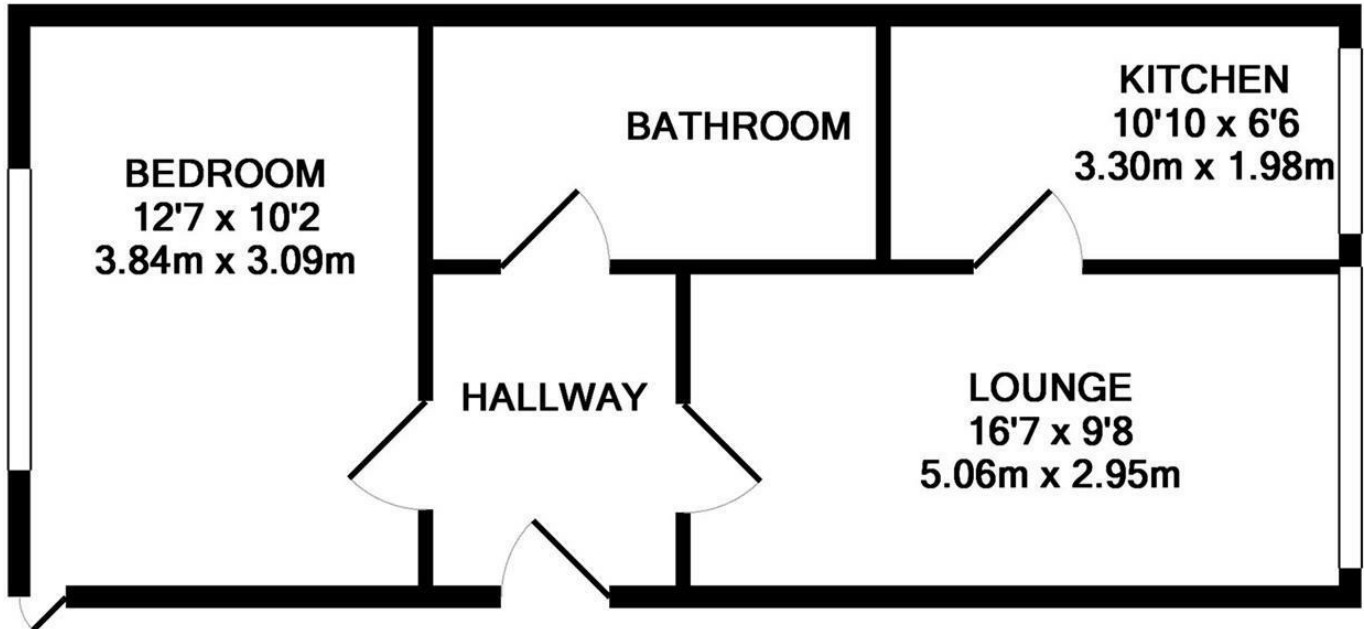

TOTAL APPROX. FLOOR AREA 367 SQ.FT. (34.1 SQ.M.)

Whilst every attempt has been made to ensure the accuracy of the floor plan contained here, measurements of doors, windows, rooms and any other items are approximate and no responsibility is taken for any error, omission, or mis-statement. This plan is for illustrative purposes only and should be used as such by any prospective purchaser. The services, systems and appliances shown have not been tested and no guarantee as to their operability or efficiency can be given

Made with Metropix ©2016

