

**FOR
SALE**



Upper Barn, Hemel Hempstead

squire | estates

This well-presented two-bedroom maisonette is situated in the highly sought-after area of Upper Barn.

Upon entering the property, you are welcomed by a convenient entrance hallway featuring a useful storage cupboard and stairs leading to the main living accommodation.

The first floor boasts a spacious and bright open-plan living and dining area, enhanced by recently installed brand-new windows that allow for an abundance of natural light. The modern fitted kitchen is accessed directly from the living space and offers a stylish, contemporary finish with up-to-date fixtures and fittings.

Both bedrooms are generously sized, providing comfortable and versatile living space. The family bathroom is well appointed and comprises a bath with an overhead shower, finished to a high standard.

Externally, the property benefits from off-street parking, adding further convenience for residents.

- 1st Floor Maisonette
- Two Bedrooms
- Spacious living/dining area
- Modern Kitchen
- Bathroom
- Great Location



First Floor

Approx. 55.0 sq. metres (591.8 sq. feet)



Ground Floor

Approx. 8.4 sq. metres (90.7 sq. feet)

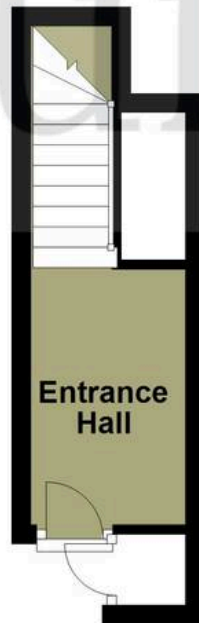

Total area: approx. 63.4 sq. metres (682.5 sq. feet)

The Floor Plan is not to Scale and measurements and areas shown are approximate and therefore should be used for illustrative purposes only. The plan has been prepared with due diligence and whilst we have confidence in the information produced it should not be relied upon. Maximum lengths and widths are represented on the plan. If there are any aspects of particular importance, you should carry out or commission your own inspection of the property. Copyright © SKMSTUDIO
Plan produced using PlanUp. □



t. 01442 233533 | e. homes@squirestates.co.uk