



72 The Cornfields, Hemel Hempstead, Hertfordshire HP1 1UB
£1,095 PCM

squire | estates

Squire Estates are pleased to present this VERY SPACIOUS two DOUBLE BEDROOM (Both with built in WARDROBES) Apartment within walking distance to MAINLINE STATION.

This well-presented top floor flat is in a quiet, residential road with good access to shops, schools and local amenities and within walking distance to the TOWN CENTRE.

Parking available.

Available NOW!







Ground Floor

Approx. 61.2 sq. metres (659.1 sq. feet)

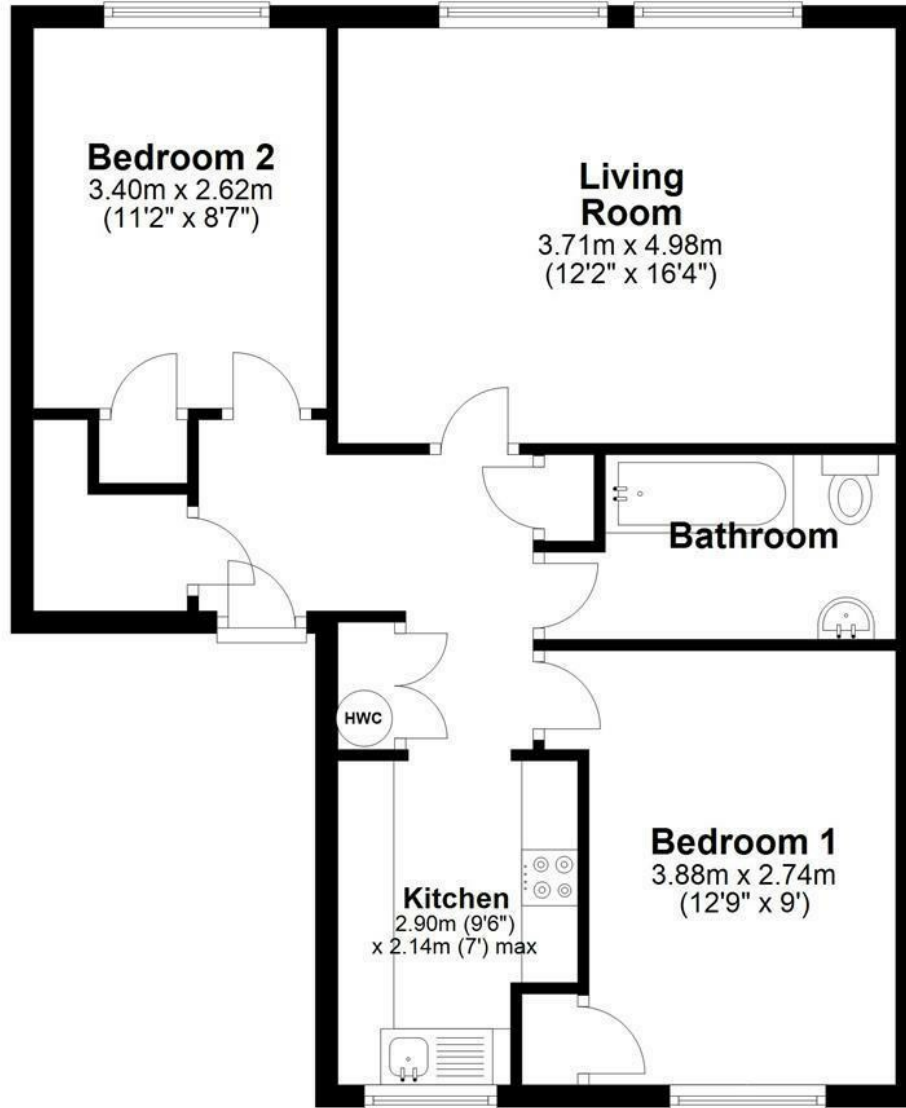

Total area: approx. 61.2 sq. metres (659.1 sq. feet)

Disclaimer - Floor plan is for marketing purposes only and is to be used as a guide - SKM Studio Plan produced using PlanUp.

Energy Efficiency Rating		
	Current	Potential
Very energy efficient - lower running costs		
(92 plus) A		
(81-91) B		
(69-80) C		
(55-68) D		
(39-54) E		
(21-38) F		
(1-20) G		
Not energy efficient - higher running costs		
England & Wales		EU Directive 2002/91/EC
Environmental Impact (CO ₂) Rating		
	Current	Potential
Very environmentally friendly - lower CO ₂ emissions		
(92 plus) A		
(81-91) B		
(69-80) C		
(55-68) D		
(39-54) E		
(21-38) F		
(1-20) G		
Not environmentally friendly - higher CO ₂ emissions		
England & Wales		EU Directive 2002/91/EC