



**103 Elstree Rd, Hemel Hempstead, Herts HP2 7QN**  
**£1,100 PCM**

squire | estates

---

**A recently refurbished two bedroom, ground floor, top specification apartment within walking distance to the Industrial Estate and a short drive to the M1 and M25 motorways. The property offers spacious modern living accommodation with an open-plan fully fitted and applianced new kitchen, lounge area, two bedrooms and a new modern bathroom suite with shower. Available from 21/01/23**



### ENTRANCE HALL

Doors to lounge, bedrooms and bathroom with access to airing cupboard

### LOUNGE/DINER

Spacious lounge/diner with light oak laminate floor, storage heater and window to rear aspect

### KITCHEN

Fitted with cream units with oak style laminate work tops, stainless steel sink and drainer and fitted oven and hob.

### BEDROOM

Main bedroom with oak style laminate floors and window to front aspect.

### BEDROOM

Second bedroom with oak style laminate floors and window to rear aspect.

### BATHROOM

Bathroom part tiled with panelled bath with shower over, WC and basin.



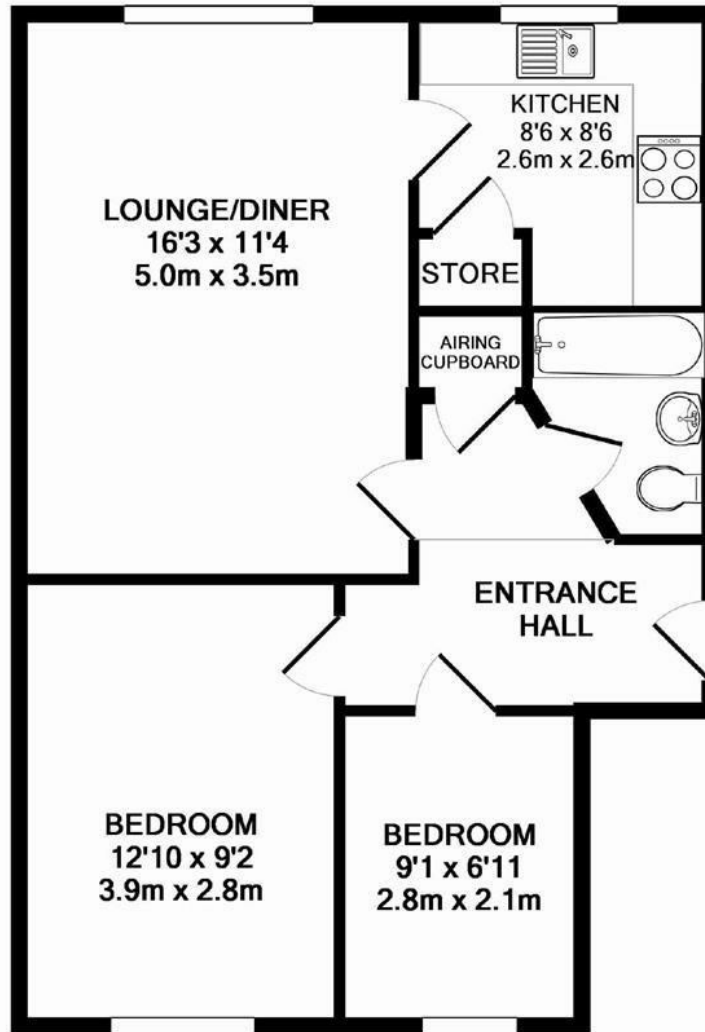

TOTAL APPROX. FLOOR AREA 524 SQ.FT. (48.7 SQ.M.)

Whilst every attempt has been made to ensure the accuracy of the floor plan contained here, measurements of doors, windows, rooms and any other items are approximate and no responsibility is taken for any error, omission, or mis-statement. This plan is for illustrative purposes only and should be used as such by any prospective purchaser. The services, systems and appliances shown have not been tested and no guarantee as to their operability or efficiency can be given

Made with Metropix ©2015

