



Overton House, 37 Alexandra Road
Hemel Hempstead, HP2 5BP

squire | estates

Overton House, 37 Alexandra Road, Hemel Hempstead

This one bedroom ground floor contemporary apartment is located within easy access of both the Town Centre and Old Town. Set in this unique Victorian development this apartment comprises of a modern open plan lounge/kitchenette area with fitted white goods, double bedroom and stylish shower room. Available from 07/03/24. Allocated parking for one car.

Features

- Contemporary ONE bedroom apartment
- Ground floor
- Open plan kitchen/lounge area
- Victorian Conversion
- Many Original Features
- Available from 07/03/24
- Allocated Parking
- Must be Seen
- EPC - C
- Council tax - B

To Book a Viewing

Please contact Squire Estates on 01442 233533.

Please note we have not tested any apparatus, fixtures, fittings, or services. Interested parties must undertake their own investigation into the working order of these items. All measurements are approximate and photographs provided for guidance only.



Energy Efficiency Rating		
	Current	Potential
<i>Very energy efficient - lower running costs</i>		
(92 plus) A		
(81-91) B		
(69-80) C	69	69
(55-68) D		
(39-54) E		
(21-38) F		
(1-20) G		
<i>Not energy efficient - higher running costs</i>		
England & Wales	EU Directive 2002/91/EC	

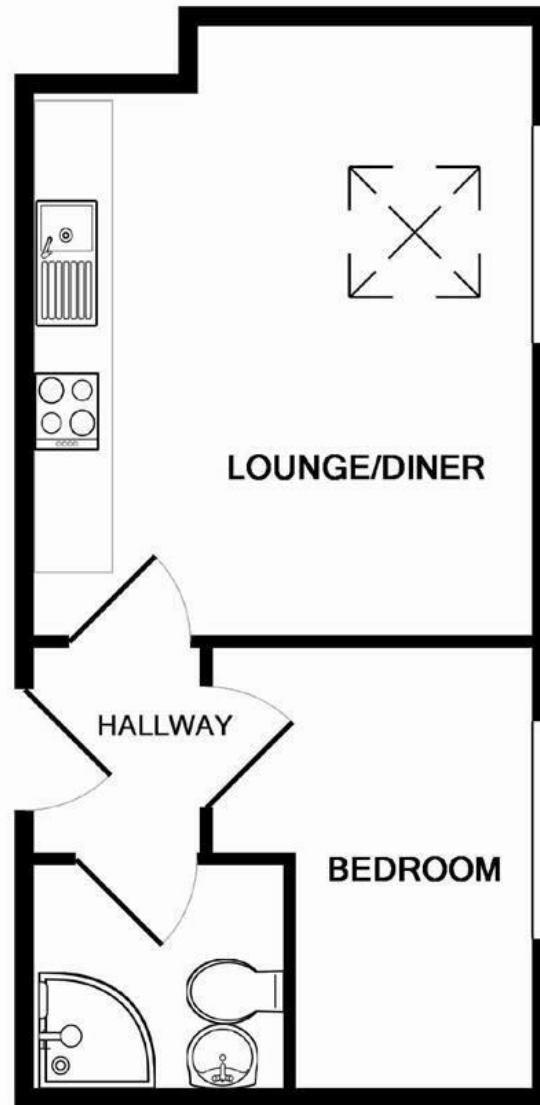

Whilst every attempt has been made to ensure the accuracy of the floor plan contained here, measurements of doors, windows, rooms and any other items are approximate and no responsibility is taken for any error, omission, or mis-statement. This plan is for illustrative purposes only and should be used as such by any prospective purchaser. The services, systems and appliances shown have not been tested and no guarantee as to their operability or efficiency can be given
Made with Metropix ©2015

