



Arran Close
Hemel Hempstead, HP3 8TQ

squire | estates

Arran Close, Hemel Hempstead

Squire Estates are pleased to offer this ground floor, one bedroom apartment which has been Recently Refurbished . The Property has gas central heating and DOUBLE GLAZED windows throughout.

Located in a quiet road and situated on the ground floor, this 500 SQ/FT. apartment offers bright and spacious accommodation, The hallway benefits from a large storage cupboard, which is currently used for storage, but could be used as an office. There is a lovely bright and spacious lounge with views over the communal gardens.

The flat benefits from lovely open views across lawns, shrubs and trees. There is a communal garden and ample residents’ parking close by.

Available NOW

Squire Estates are pleased to offer this ground floor, one bedroom apartment which has been Recently Refurbished . The Property has gas central heating and DOUBLE GLAZED windows throughout.

Located in a quiet road and situated on the ground floor, this 500 SQ/FT. apartment offers bright and spacious accommodation, The hallway benefits from a large storage cupboard, which is currently used for storage, but could be used as an office. There is a lovely bright and spacious lounge with views over the communal gardens.

The flat benefits from lovely open views across lawns, shrubs and trees. There is a communal garden and ample residents’ parking close by.

Available NOW

Please note we have not tested any apparatus, fixtures, fittings, or services. Interested parties must undertake their own investigation into the working order of these items. All measurements are approximate and photographs provided for guidance only.



Features

- Recently Refurbished
- One double bedroom
- Ground floor
- Close to local school & amenities
- Bright & spacious
- EPC - C
- Council tax - B
- Available Now

To Book a Viewing

Please contact Squire Estates on 01442 233533.

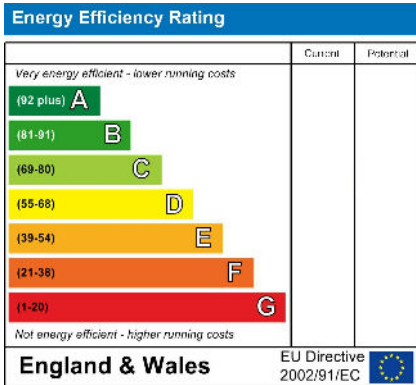

Floor Plan

Approx. 46.5 sq. metres (500.5 sq. feet)

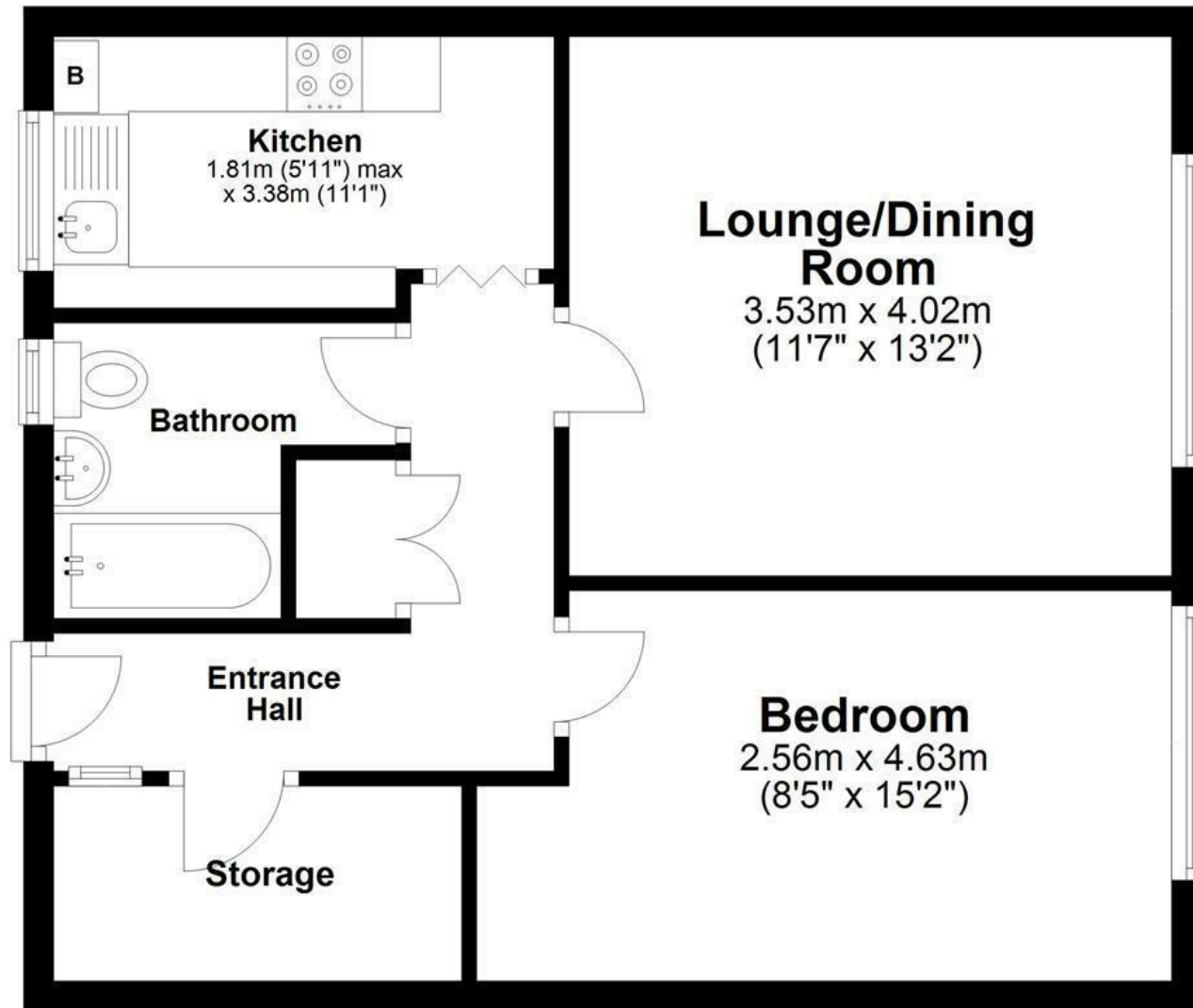

Total area: approx. 46.5 sq. metres (500.5 sq. feet)

Disclaimer - Floor plan is for marketing purposes only and is to be used as a guide - SKM Studio
Plan produced using PlanUp.



67 Marlowes, Hemel Hempstead, Hertfordshire, HP1 1LE
01442 233533 | www.squireestates.co.uk