



35 The Pastures, Hemel Hempstead, Hertfordshire HP1 2TN
£1,200 PCM

squire | estates

****PETS ACCEPTED**** This well presented **ONE DOUBLE BEDROOM** cluster home with its own **GARDEN** is situated on the ever popular **FIELDS END** development. Deceptively spacious this well presented accommodation comprises: **GAS CENTRAL HEATING**, fully fitted and applianced modern kitchen, bright and airy living room and bathroom with allocated parking. **Pets Accepted, Available Now**







GROUND FLOOR
231 sq.ft. (21.4 sq.m.) approx.

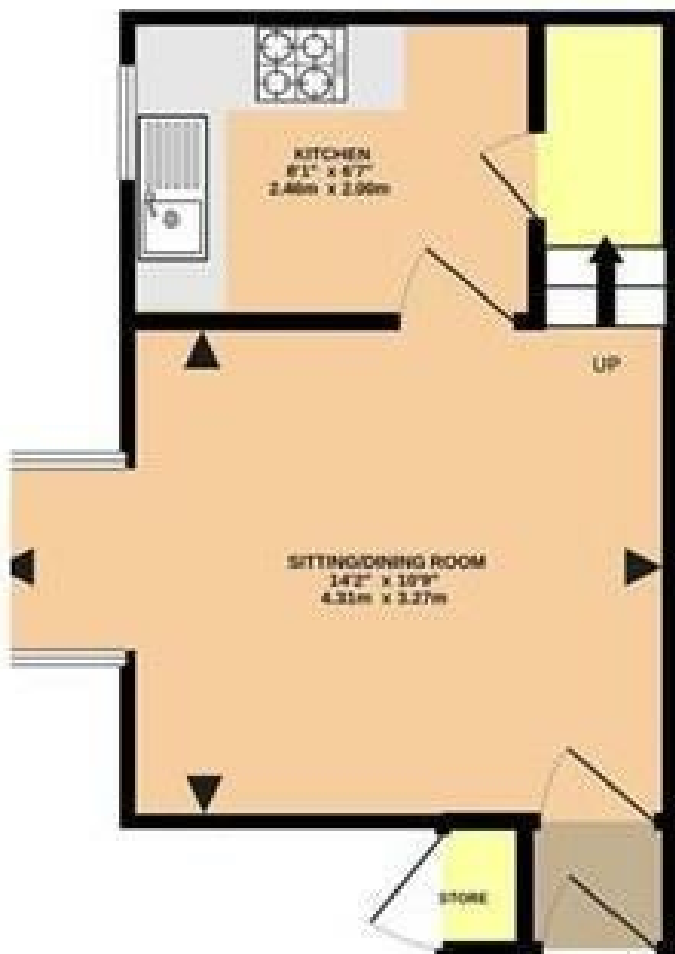

1ST FLOOR
217 sq.ft. (20.2 sq.m.) approx.



THE PASTURES, HEMEL HEMPSTEAD HP1 2TN

TOTAL FLOOR AREA: 448 sq.ft. (41.6 sq.m.) approx.

No accuracy in this image, text or measurements is guaranteed
Made with Meeplex ©2022

Energy Efficiency Rating		
	Current	Potential
Very energy efficient - lower running costs		
(92 plus) A		90
(81-91) B		
(69-80) C		65
(55-68) D		
(39-54) E		
(21-38) F		
(1-20) G		
Not energy efficient - higher running costs		
England & Wales		EU Directive 2002/91/EC
Environmental Impact (CO ₂) Rating		
	Current	Potential
Very environmentally friendly - lower CO ₂ emissions		
(92 plus) A		
(81-91) B		
(69-80) C		
(55-68) D		
(39-54) E		
(21-38) F		
(1-20) G		
Not environmentally friendly - higher CO ₂ emissions		
England & Wales		EU Directive 2002/91/EC