



Burns Drive  
Hemel Hempstead, HP2

**squire** estates  
Every home tells a story

## Burns Drive

\*SHARE OF FREEHOLD\* a spacious TWO bedroom, second floor apartment with COMMUNAL GARDENS and potential to purchase a parking space.

Offering well planned accommodation throughout, the rooms are bright and airy with the main rooms accessed from the entrance hall which has a good size storage cupboard. The lounge/dining room has views over the communal gardens. The separate kitchen is fitted with wall and base units. The master bedroom is a large double room and bedroom two is a good size single room. The bathroom has a bath, sink and a WC.

Parking places are available for purchase.

Situated in Hemel Hempstead, with its comprehensive range of shopping facilities and recreational amenities including, an IMAX cinema, The Snow Centre, an ice rink and the XC centre with a range of activities and multiple restaurants.

The property is a short drive from Hemel Hempstead mainline station with a fast and frequent railway service into London Euston in 24 minutes. Close by are both the M1 and M25 motorways, making the area ideal for commuters.

Close by, Gadebridge Park runs from the northern edge into the heart of the town along the Gade valley, providing acres of space for recreation, including bowling, crazy golf, croquet, giant chess and play areas.

## Features

- Two bedroom apartment
- SHARE OF FREEHOLD
- Bright, spacious lounge/dining room
- Separate kitchen
- Bathroom
- Second floor
- Residents parking available to purchase

## Viewing

Please contact Squire Estates on 01442 233533

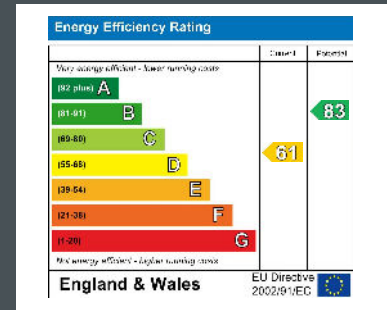

# Floor Plan

Approx. 49.8 sq. metres (535.8 sq. feet)

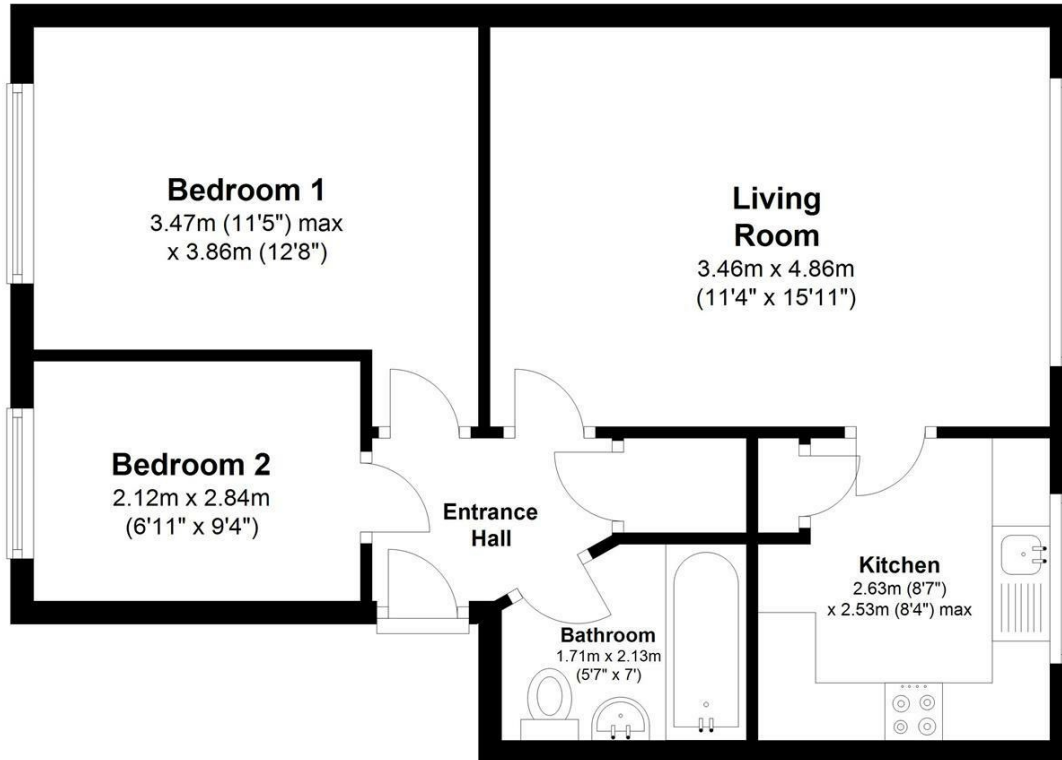
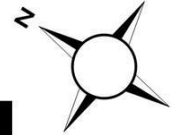

Total area: approx. 49.8 sq. metres (535.8 sq. feet)

