



Elstree Road  
Hemel Hempstead, HP2

squire | estates

---

## Elstree Road

SHARE OF FREEHOLD. A spacious TWO BEDROOM second floor (top floor) apartment with RESIDENTS PARKING, 995 years remaining lease, located in a popular road close to local shops and primary schools.

The property comprises of an entrance hall opening to a bright and spacious lounge/dining room with full height windows affording lovely open views over communal gardens. The kitchen is fitted with ample wall and base units and space for washing machine, tumble dryer, cooker, and a freestanding fridge freezer. The kitchen also has a large storage cupboard/larder providing more storage. There are two bedrooms, one double and one large single. The bathroom is fully tiled with a modern white suite with a bath and power shower over, pedestal wash hand basin and WC.

Externally there are communal gardens and residents parking.

The property benefits from Share of Freehold

This property is situated on a residential road in the Woodhall Farm area of Hemel Hempstead close to local shops and amenities. Located nearby is Sainsbury's supermarket and offers excellent links to Redbourn and Harpenden. Woodhall Farm is also close to Maylands Industrial Estate, and is ideal for families as it is home to two primary schools: Holtsmere End Primary School & Brockswood Primary School.

## Features

- Two bedroom apartment
- Second floor (top)
- Large Lounge & Kitchen
- Share of freehold
- Fully tiled bath/shower room
- Residents parking
- Council tax band B

## Viewing

Please contact Squire Estates on 01442 233533

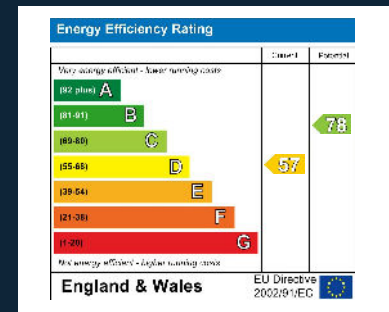

# Floor Plan

Approx. 49.8 sq. metres (535.8 sq. feet)

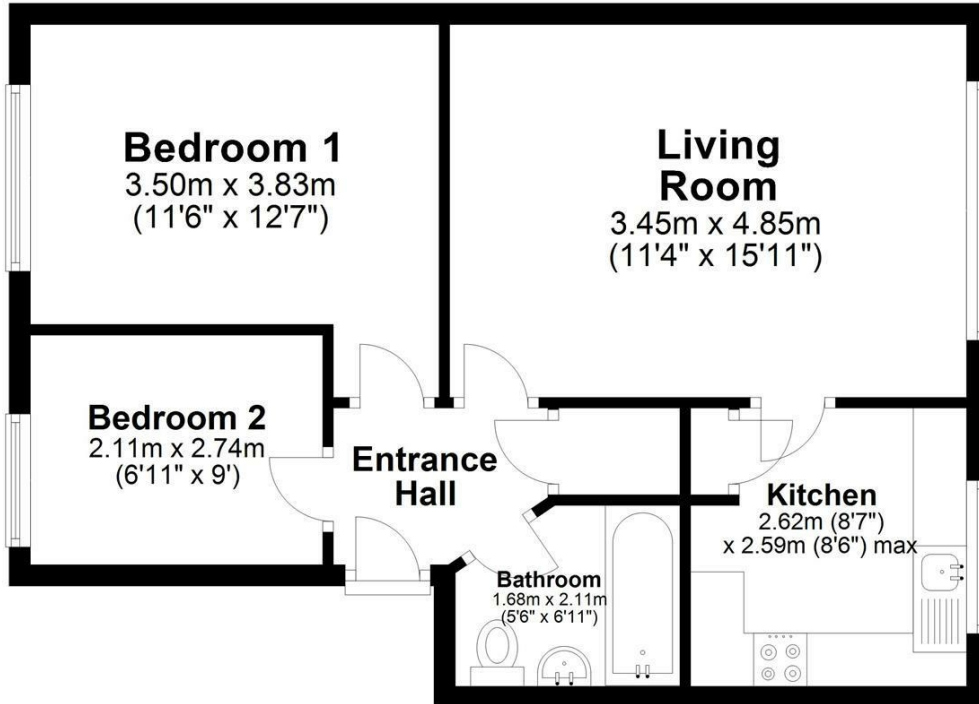

Total area: approx. 49.8 sq. metres (535.8 sq. feet)

Disclaimer - Floor plan is for marketing purposes only and is to be used as a guide.  
Plan produced using PlanUp.





67 Marlowes, Hemel Hempstead, Hertfordshire, HP1 1LE  
01442 233533 | [www.squirestates.co.uk](http://www.squirestates.co.uk)