



squire | estates

Tattershall Drive
Hemel Hempstead, HP2

squire | estates

Tattershall Drive

This one-bedroom second-floor flat, situated at the top level, offers an ideal opportunity for those seeking a residence in need of some updating. Boasting a bright and inviting ambiance, the flat features a spacious lounge illuminated by a generous picture window, allowing ample natural light to filter through.

The kitchen is equipped with both floor and wall units, providing practical storage solutions and offering potential for modernization to suit personal preferences.

A comfortable double bedroom provides a cosy retreat, and a bathroom, offers essential facilities.

Externally, the property benefits from communal grounds, providing residents with outdoor space for relaxation and leisure activities.

Ideal first time buy or investment.

With its convenient location and scope for improvement, this flat presents an attractive prospect for buyers looking to create a personalized living space within a well-established community setting.

Features

- Top Floor One Bedroom Flat
- Bright lounge with views over woodland
- Double bedroom
- Communal gardens
- Low lease 52 years
- Rental value £950-£1000pcm
- Sold with vacant possession
- Service Charge £1256pa

Viewing

Please contact Squire Estates on 01442 233533

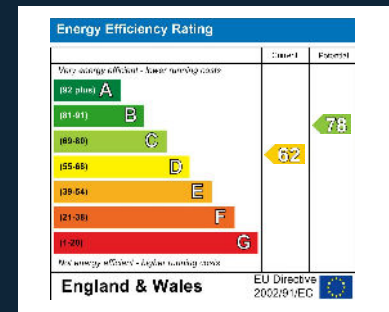

Floor Plan

Approx. 37.4 sq. metres (402.9 sq. feet)

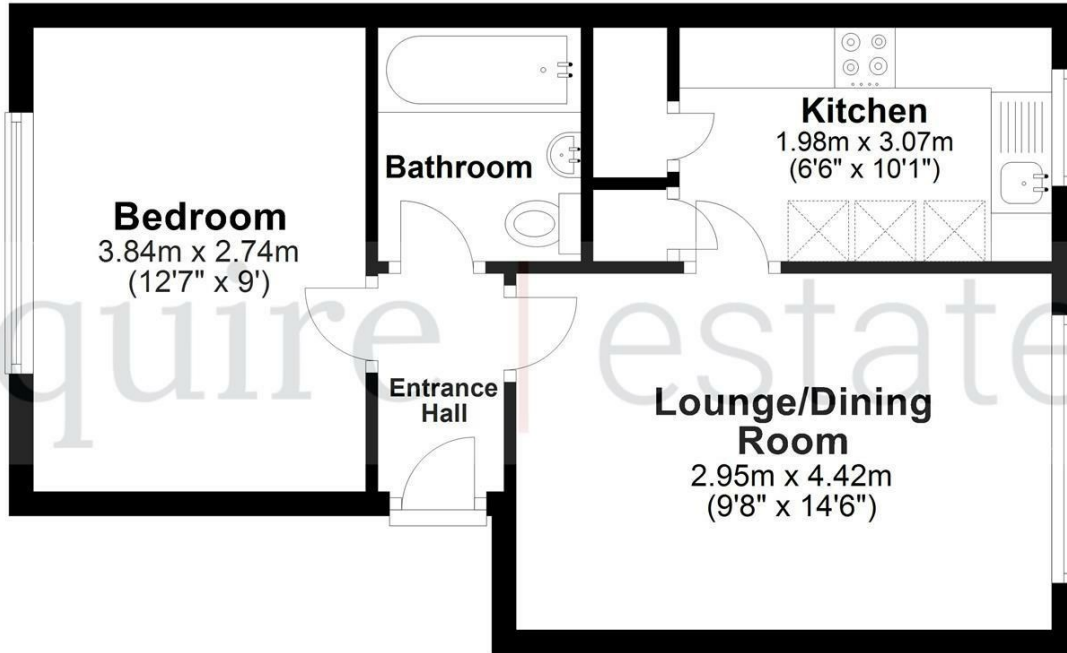

Total area: approx. 37.4 sq. metres (402.9 sq. feet)

Disclaimer - Floor plan is for marketing purposes only and is to be used as a guide

- SKM Studio

Plan produced using PlanUp.

